

<Bus> Exit from the East Exit at Hachinohe Station and take the bus headed to the Hachinohe downtown area 中心街方面. It will take about 25 min. to reach the Youkamachi Hachinohe Downtown Terminal 八日町. From here it is a 2 min. walk to hacchi.

<Train> Take the Hachinohe JR Line from Hachinohe Station to Hon-Hachinohe Station. It is an 11 min. walk from there.

<Car> 15 min. from Hachinohe Station

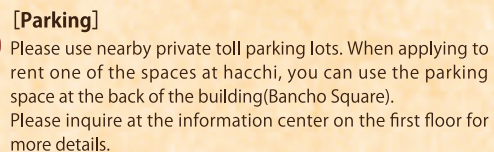
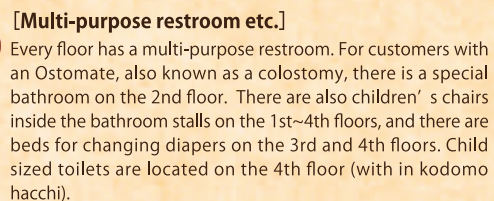
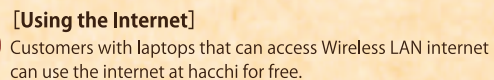
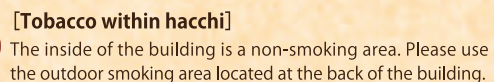
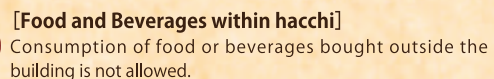

- Art
- Gallery
- Display
- Sightseeing
- Theater
- Information
- Shop
- Cafe
- Lounge
- Radio

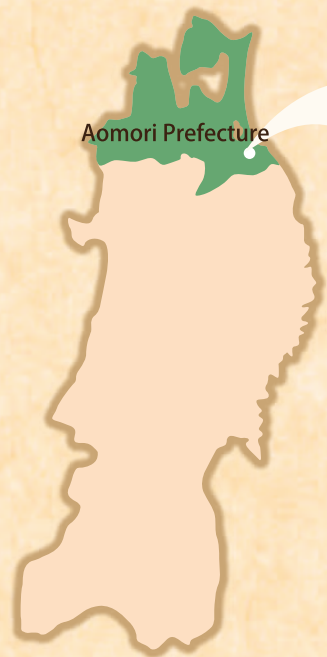

► Summary of Hachinohe City

Hachinohe City, with a population of about 237,000 people, faces the Pacific Ocean and is the second largest city in Aomori prefecture. As a fishing city it prides itself on having some of the highest catch volumes in Japan. Hachinohe is also one of the strongest industrial

cities in Northern Tohoku. In addition, Hachinohe has developed into an international freight distribution center that represents Northern Japan through fixed international trade container routes with North America, China, Korea and Southeast Asia.

Hachinohe is also blessed with beautiful nature, such as the black tern gull hatching grounds at Kabushima or the natural grass lawns at Tanesashi Coast. With the summer festival, [Sansha Taisai] and the winter festival [Enburi], which are designated as national significant intangible folk cultural assets, and the Historical Korekawa Archaeological Site that continues to inform us of the beauty of Jomon Culture, Hachinohe is a city teeming with history, tradition and culture.

Here at hacchi, we showcase the appeal of these numerous local Hachinohe resources through permanent tourism exhibits. The entrance to hacchi acts as a portal that connects us the various attractions Hachinohe has to offer.

► Summary of Hachinohe Portal Museum

The Hachinohe Portal Museum [hacchi] opened in 2011 as the focal point for new exchange and creation. Through the creation of lively energy and the promotion of tourism and culture, we aim to invigorate the downtown area and all the incorporated areas of Hachinohe City as well. "Creating new city attractions while treasuring local resources." With this concept, we will use

the promotion of urban development, cultural art, tourism, craftsmanship and child-rearing support as a base to awaken new activities and interest in our city. We are involved in many projects that encourage social exchange between people. An energetic city ! Energetic Hachinohe people ! That is our mission.

► Special Characteristics of the Building

[hacchi] is located in the downtown area where old side alleys (yokocho) and small lanes still remain standing. We incorporated these characteristics of the downtown area into the interior design of hacchi. With walkways that remind you of side alleys and small lanes, and wide open spaces resembling large city squares, the inside of hacchi was built to resemble a small city.



► Hachinohe artists

Many of the permanent tourism exhibits concerning the attractions of Hachinohe were made by artists that live in Hachinohe. The skills of the master artists shown in the art compositions on display are another irreplaceable resource of Hachinohe.



[Various events take place at hacchi]





1 Mechanical Clock with Snapping Lion' s Heads (Hacchi Square)

1st Floor



1 Mechanical Clock with snapping Lions Heads

This clock was built with the motif of Houryou Kagura, a folk dance that prays for good health and fortune. Dancers wear costumes with wooden lion' s heads, and during the dance they snap the jaws of the lions head at the same time in a particular syncopated rhythm. Every hour the lion' s heads at hacchi snap their jaws, and inform visitors of the time.

2 Yawata Horse

Historically, the Hachinohe area was a famous horse breeding area. It is said that the first Yawata Horse was made about 700 years ago, and is the oldest type of traditional toy from this area.

3 Tanesashi Booth

The Tanesashi Coastline has a rough and jagged shape that is particular to ria coasts. It also has sand beaches and natural grass lawns. This abundant variety of scenery makes the Tanesashi Coastline into the perfect scenic spot. There is also a walking trail called the "flower shore" . Visitors that walk along the trail greatly enjoy the large variety of beach and alpine plants to be found along the trail.



3 Morning Market [asaichi] and Side Alley [yokocho] Booth

The lively morning markets [asaichi] that are held in several places within Hachinohe city are very well known. The morning markets are overflowing with fresh seafood, vegetables, fruit, side dishes and carefree smiles. Night food stands in side alleys, or [yokocho] give off a nostalgic atmosphere. You can enjoy traditional local food as well as a special hospitality that can only be found at these side alleys.

3 National Treasure Booth

The beautiful clay figure and armor shown in these pictures are the three national treasures that are located in Aomori prefecture. They are all located in Hachinohe, and can be seen in person. The art compositions that you see before you are by current artists and reflect the beauty of Hachinohe.



3 Traditional Craft Booth

Nanbu Sakiori and Nanbu Hishisashi are traditional crafts that started during the Edo period. They developed during a time when cloth was hard to come by. The wisdom and ingenuity of our ancestors created an art from that continues to be passed on to this day.

3 Kabushima Black Tern Gull Booth



Every year in early spring, the black tern gulls fly home to Kabushima. During breeding season in June the island is buried in 40,000 black tern gulls that come to mate and hatch their young. Kabushima is the only place in Japan where you can see black tern gulls raising their young at such a close range. Accordingly it has been designated a natural monument.

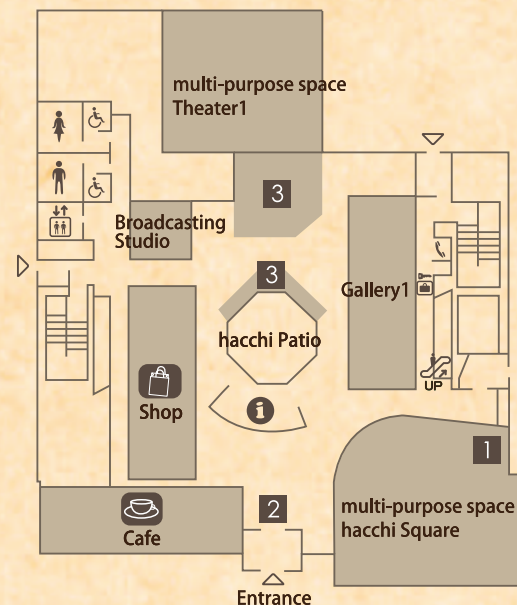



A photograph of a performance during the live theater festival (Multi-purpose Space Theater 2)

2nd Floor



1

1 Marine Products City Hachinohe

Hachinohe is considered one of Japan's fishing industries cities, and has the highest squid catch volumes in all of Japan. Hachinohe is also blessed with an abundance of mackerel and other seafood. The boat and fishing tools shown in this exhibit offer us a glimpse into the fishing industry in Hachinohe.

2 Hachinohe Enburi

The Hachinohe Enburi festival features dancers wearing hats that represent horse's heads, and is held every year from February 17th for 4 days at various places within Hachinohe city.

It is a festival that both prays for a bountiful harvest and signals the long-awaited arrival of spring after a difficult, cold winter. This festival was designated a national significant intangible folk cultural asset.



2



2

3 Hachionhe Sansha Taisai

Every year from July 31st to August 4th for 5 days, the summer festival [Hachinohe Sansha Taisai] is held in the downtown area. It is a festival that prays for a bountiful harvest with about 290 years of history.

Spectators are overwhelmed by the spectacular display of the main procession of the three participating shrines and the 27 floats that follow. This festival was designated a national significant intangible folk cultural asset.



3



4

4 Hachinohe History, Food and Daily Life

This is a miniature replica of the morning market in Hachinohe. Hachinohe food culture developed from the nearby sea and mountains.

There are also exhibits about popular ice skating activities, the peculiar habit of visiting bathhouses very early in the morning and the Nango Jazz festival.



A Taste of Local Food



On the 1st ~3rd Floors, there are food stands where you can eat local foods. Please give local Hachinohe food a try!



A koto performance (Tatami Studio)

3rd Floor

1 Hachinohe Industries

Hachinohe is an industrial city that prides itself on having top production values in Northern Tohoku area. This exhibit showcases this industrial side of Hachinohe through made in Hachinohe products that are well known to local people.

Are the artificial crystals power stones? If you place your hands on them, you may receive some mystical energy.



1

2 Ancestors with Connections to Hachinohe ~ Unforgettable People ~



2

An exhibit about the people who built the foundations of what is now Hachinohe City, as well as famous people who have a strong connection to Hachinohe. One of these people is Yoshida Hatsusaburo, an author whose work created the modern Japanese image of Mt. Fuji, sakura and geisha. Hatsusaburo traveled extensively within Japan as well as overseas. Yet he remained deeply fond of the Tanesashi Coastline, and is quoted as saying that among all the sights he had seen during his various travels, the Tanesashi Coast was the most beautiful.

3 Jomon Hachinohe



3

Excellent remains of Jomon culture can be found in Hachinohe. You can see a replica of the National Treasure 「Clay Figurine with clasping hands」 (We also recommend seeing the real thing at the Korekawa Jomon Archeological Museum which opened in 2012)



Lounge Space



On each floor there are lounge areas that you can use freely to relax or to consume the edibles that you have bought within hacchi.



Gallery Space



On the 1st ~3rd Floors there are gallery spaces which are used during exhibitions to exhibit paintings, photographs, etc.

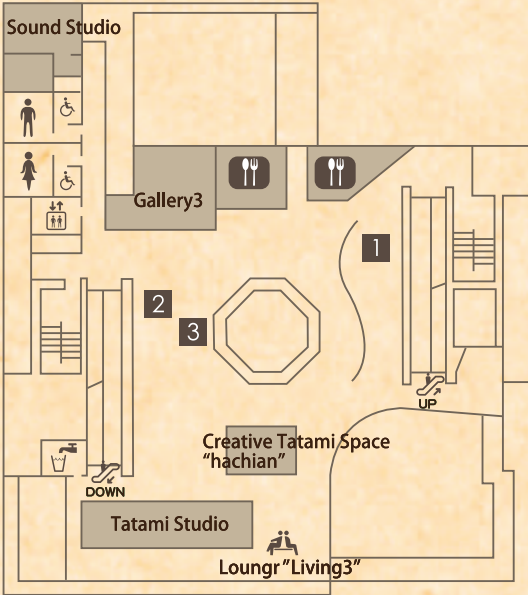



A space for children and parents to play together (kodomo hacchi)

4th Floor

1 kodomo hacchi

A kids room filled with the warmth only materials specially from Aomori Prefecture can provide, where children and adults can have fun together through play. Child-rearing advice is also available.

Open Hours / 9:30~16:30
Cost / 100 per person
(pre-school children are free)

2 Arts & Crafts Studio Shop



These studios serve as both a workshop and store, where customers can see how the artists make their handcrafts before buying them.

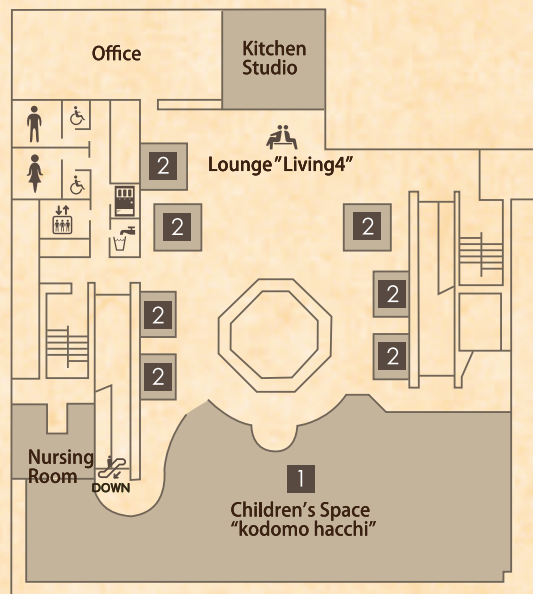

The interior of Artist Residence

5th Floor

1 Open Studio • Artist Residence

This is usually a multi-purpose studio that is open to the public. There are also rooms that serve as residences for artists that want to create art projects for the downtown area.



[Affection towards people who like alcohol ~Only You Theater~] featuring side alleys



[Hachinohe Rumors] featuring the shopping district

※Please use either the elevators or the staircase to reach the 5th Floor.